



VNFM1C51AR

2MP Night Vision Marine IP Camera



Cost effective, Feature rich
2MP Full HD IP Camera
Special for Marine environment
Smart H.265/H.264
Super Low light Night Vision



Key Features

- 1/2.8" 2MP Sony CMOS image sensor
- 1920(H)x 1080(V) 2MP /30fps
- Smart H.265/H.264
- 4.0mm wide angle fixed Lens
- Triple Streaming of H.265, H.264, and M-JPEG
- Real-time 30fps to all triple codecs
- VBR/CBR/SRC in H.265/H.264
- Ultra SRC (Smart Rate Control)
- Adjustable frame rate
- Real WDR (120dB)
- 2D+3DNR, Smart IR
- Corridor view in H.265/H.264
- 0.1Lux in Color/0'Lux in BW IR (Starlux)
- Long range IR Night vision
- Advanced ROI (Region Of Interest)
- Power/Network status indication
- Motion detection
- Tool-Free 3-Axis
- 12VDC/ IEEE802.3af POE
- ONVIF Conformant (Profile-S)
- Waterproof (IP68)
- Rust free against salty environment
- Includes Windows-based IP Installer and license-free 16 channel NVR (Network Video Recorder) software

Dimensions (Unit: mm)

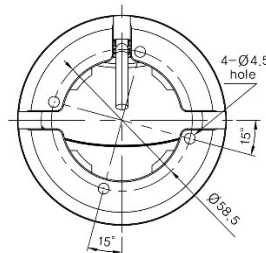
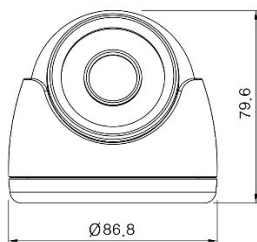

Cable out

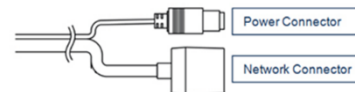



Specification

2MP Night Vision Marine IP Camera

MODEL	VNFM1C51AR
System	
CPU	Cortex-A9 816 MHz CPU
Flash	2Gbit Flash memory
SDRAM	2Gbit DDR3
Camera	
Image sensor	2.07 Megapixel 1/2.8" SONY progressive scan CMOS
Total Pixels	1945(H) x 1109(V) 2.16 Megapixel
Effective Pixels	1945(H) x 1097(V) 2.13 Megapixel
S/N Ratio	More than 50dB
Min. Illumination	0.1 Lux in Color/ 0Lux in BW (IR On)
IR Distance	20M
Day & Night	True DN w/ ICR Filter change
Lens	2.8mm Wide angle Megapixel Board Lens
Video	
Video compression	H.265 Main profile @Level4.0, / H.264 BP/MP/HP profile @Level4.0 / Motion JPEG
Resolutions	Up to 1920 x 1080P 2MP
Frame rate	H.265/H.264 Up to 30fps with 1920x1080p, H.265/H.264 Up to 30fps with 720p, H.264/MJPEG Up to 30fps with VGA resolution
Video streaming	Multi stream with H.265, H.264, MJPEG, Adjustable frame rate, VBR/CBR/SRC (Smart Rate Control)
Backlight	True-WDR, ATR
Shutter Speed	1/30 ~ 1/10,000 sec
Corridor view	Corridor view in H.265/H.264
Noise reduction	3DNR
Image setting	Brightness, Contrast, Sharpness, Day & Night, Auto White Balance, Auto exposure, Privacy mask, DSS, Corridor-view, Mirror/V-Flip, etc.
Cable Out	
CVBS Video	X
12VDC	DC Male Jack x 1
POE	RJ45 Jack x 1
System Integration	
Security	Password Protection, User access log, HTTPS encryption
Supported protocol	HTTP, HTTPS, DNS, RTSP, RTP, TCP, UDP, ICMP, DHCP
Intelligent video	Object based Motion detection with 12x 12 block.
Alarm trigger	Motion detection, External input (NC/NO)
Alarm events	File upload via FTP/Email, Notification via Email/FTP/TCP, External alarm output
Video buffer	5MB pre-alarm and 180 sec (max) post-alarm
Firmware upgrade	Remote upgrade via network
API	CGI Interface document
General	
Power Source	DC12V/1.5A, PoE (Power over Ethernet): 802.3af
Power Consumption	Max. 3.5W with IR ON
Net Weight	410g
Status indication	R (Power only), G (Power & Network Connected)
Dimension	89mm (Dia. Ø) x 209mm(W)
Environmental	
Weather resistance	IP67
Vandalism resistance	IK10
Operating Temperature	-40 degree ~ 60 degree Celsius (-14F~140F)
Storage Temperature	-20 degree~60 degree Celsius (-4F~140F)
Software	
Included Software	NVR C/S (16 Channel), IP Installer (Windows only)

Specification is subject to change without prior notice.